

PT 16/20L

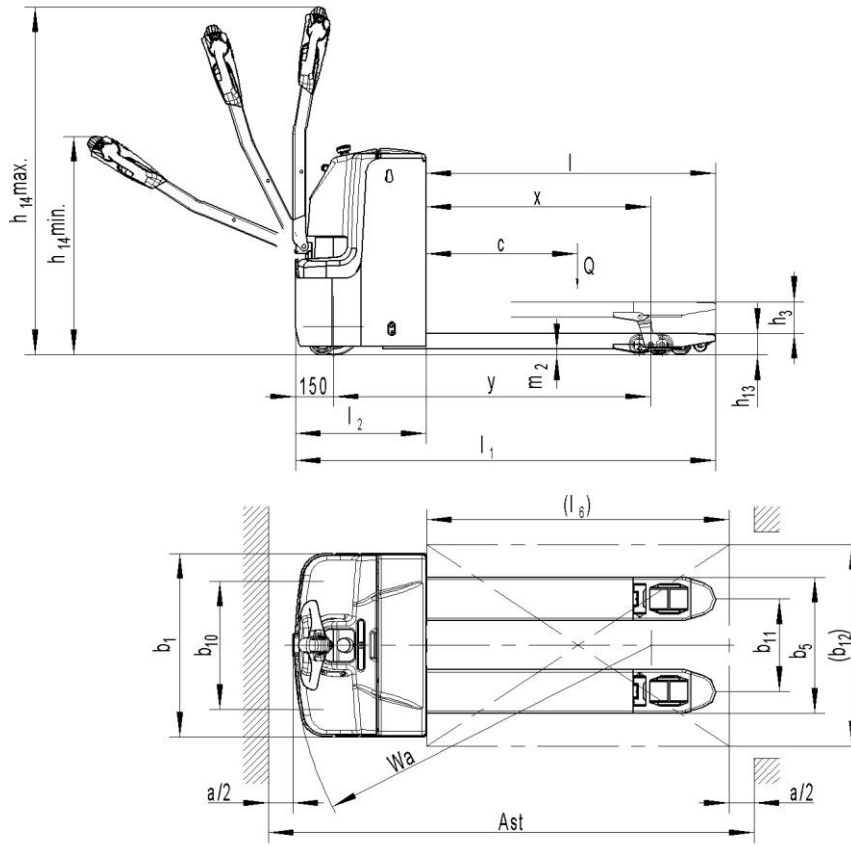

PT 25L

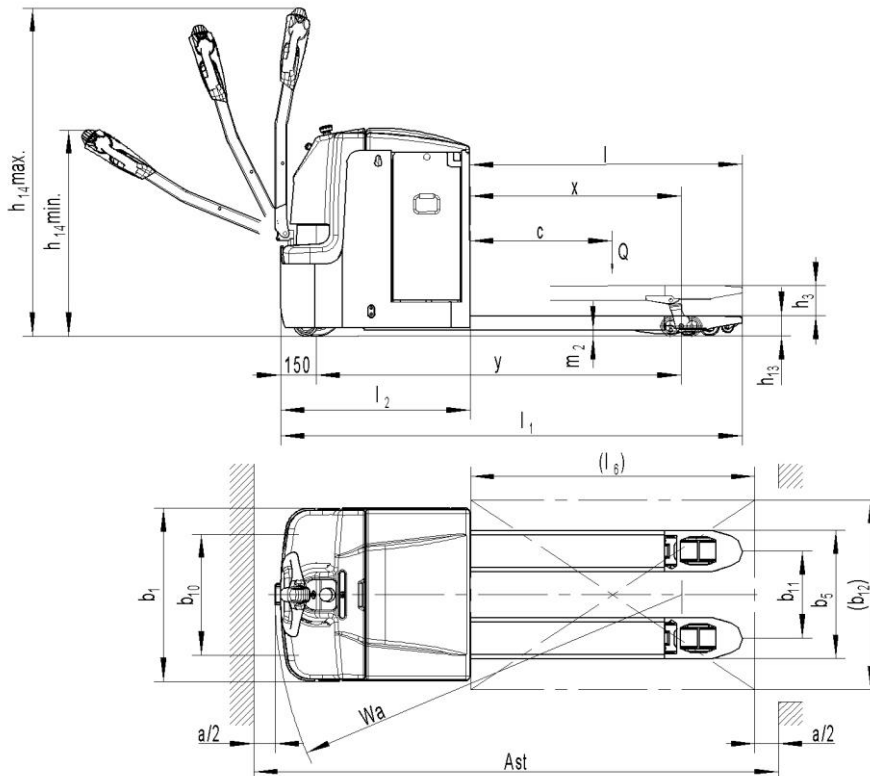



Type sheet for industrial truck acc. to VDI 2198

Type sheet for industrial truck acc. to VDI 2198						
Distinguishing mark	1.2	Manufacturer`s type designation		PT 16L	PT 20L	PT 25L
	1.3	Power(battery,diesel,petrol gas>manual)		Battery		
	1.4	Operator type		pedestrian		
	1.5	Load Capacity / rated load	Q (t)	1.6	2.0	2.5
	1.6	Load centre distance	c (mm)	600		
	1.8	Load distance, centre of drive axle to fork	x(mm)	892		
	1.9	Wheelbase	y (mm)	1261	1327	1541
Weight	2.1	Service weight	kg	445	535	720
	2.2	Axle loading, laden front/rear	kg	715/1330	855/1680	1020/2200
	2.3	Axle loading, unladen front/ rear	kg	345/100	415/120	530/190
Tires, chassis	3.1	Tires		, Polyurethane (PU)		
	3.2	Tire size, front	∅ x w (mm)	∅230X70		
	3.3	Tire size, rear	∅ x w (mm)	∅84X84		
	3.4	Additional wheels (dimensions)	∅ x w (mm)	∅100X40		
	3.5	Wheels, number front/ rear(x=driven wheels)		1x+2/4		
	3.6	Tread, front	b ₁₀ (mm)	510		
	3.7	Tread, rear	b ₁₁ (mm)	367/512		
Dimensions	4.4	Lift height	h ₃ (mm)	125		
	4.9	Height of tiller in drive position min. / max.	h ₁₄ (mm)	820/1335		
	4.15	Height, lowered	h ₁₃ (mm)	85		
	4.19	Overall length	l ₁ (mm)	1670	1735	1950
	4.20	Length to face of forks	l ₂ (mm)	520	595	810
	4.21	Overall width	b ₁ (mm)	729		
	4.22	Fork dimensions	s/e/l (mm)	60/173/1150		
	4.25	Distance between fork-arms	b ₅ (mm)	540/685		
	4.32	Ground clearance, centre of wheelbase	m ₂ (mm)	25		
	4.33	Aisle width for pallets 1000 x 1200 crossways	Ast(mm)	1885	1955	2175
	4.34	Aisle width for pallets 800X1200 lengthways	Ast (mm)	1935	2005	2225
4.35	Turning radius	Wa (mm)	1440	1490	1750	
Performance	5.1	Travel speed, laden/ unladen	km/h	5.7/6.0		5.5/6.0
	5.2	Lift speed, laden/ unladen	m/s	0.025/0.035	0.022/0.030	0.035/0.045
	5.3	Lowering speed, laden / unladen	m/s	0.035/0.030	0.035/0.035	0.040/0.040
	5.8	Gradeability, laden/ unladen	%	8/15		
	5.10	Service brake		Electromagnetic		
Motors	6.1	Drive motor rating S2 60min	kW	1.3		1.7
	6.2	Lift motor rating at S3 10%	kW	0.8		2.2
	6.3	Battery acc. to DIN 43531 /35 / 36 A, B, C, no		2VBS	2PzS	3PzS
	6.4	Battery voltage, nominal capacity K5	V/Ah	160	210	350
	6.5	Battery weight (minimum)	kg	150	215	285
	6.6	Energy consumption acc. to VDI cycle	KWh/h	0.44	0.39	0.82
	8.1	Type of drive control		AC -Speed Control		
	8.4	Sound level at driver`s ear acc. to EN 12053	dB(A)	67	69	65